

## How to access resources with your passport account

\*Only confirmed Reading Friends projects can gain access to Reading Friends resources. If you'd like to find out more about running Reading Friends or want to volunteer or join in, please email us at [readingfriends@readingagency.org.uk](mailto:readingfriends@readingagency.org.uk)

1. On the <https://readingfriends.org.uk/> website, click on **Login** in the top right-hand corner.

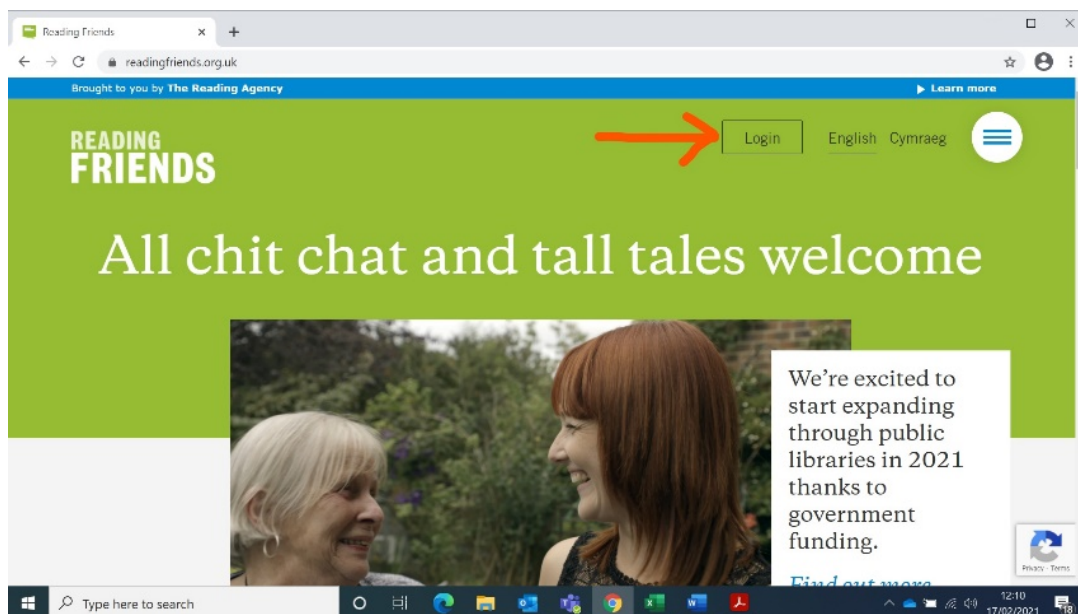

2. Remember to log in with your **username**. This will be what you set up when you created your Passport Account (it might not be your email address). Your username is case-sensitive. If you have forgotten your username, email [readingfriends@readingagency.org.uk](mailto:readingfriends@readingagency.org.uk) and we will be able to tell you what it is. Press Log in.

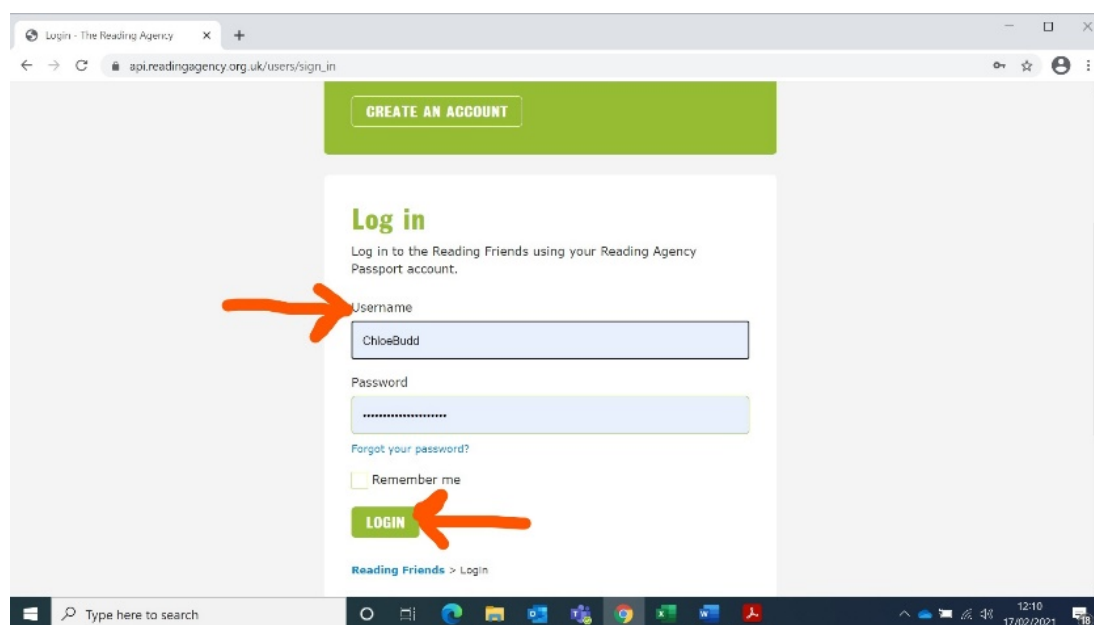

3. Click on “Sign in as **username**” next to the white figure with the green background.

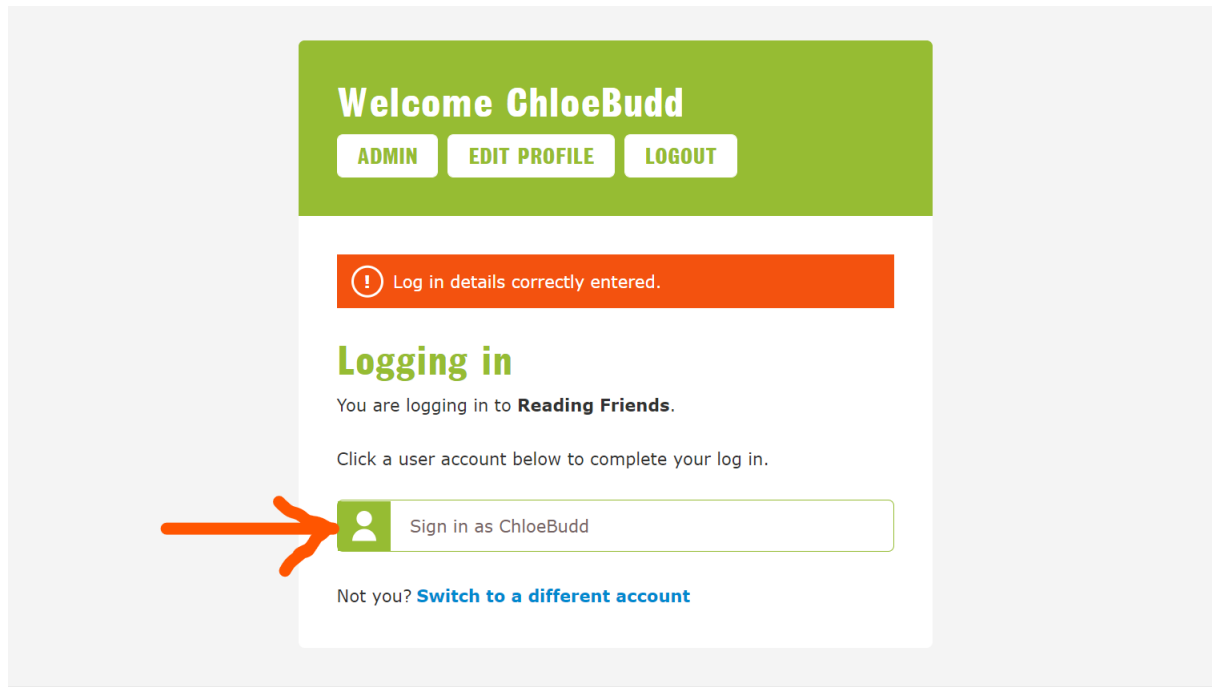

4. You are now logged in. The Reading Friends resources can be found by clicking on the white circle with the three blue lines in the top right-hand corner, and then selecting resources.

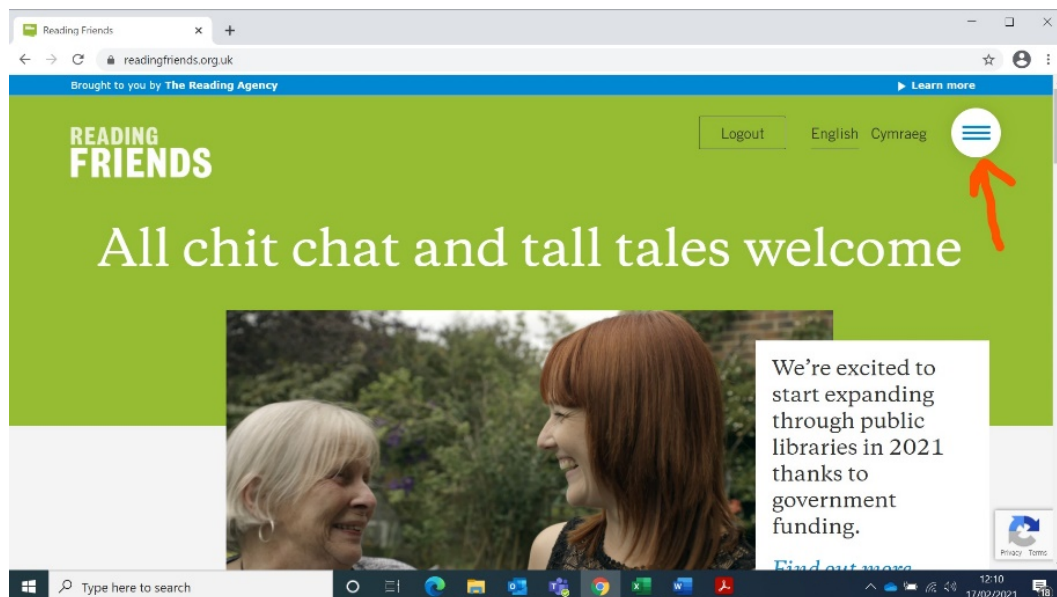

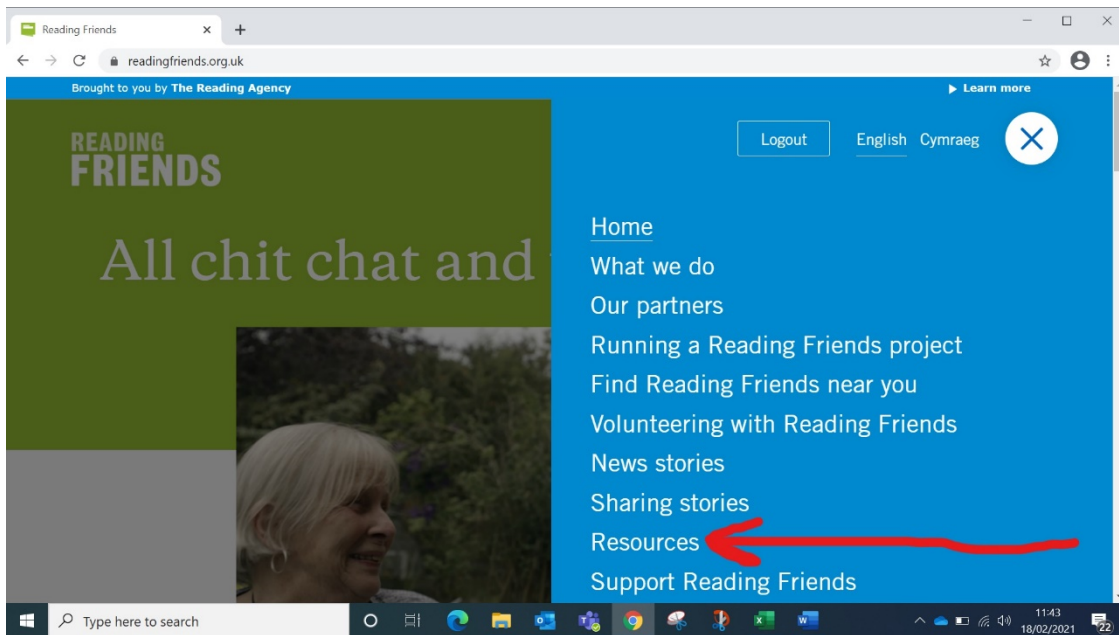

5. This will take you to our Reading Friends resources page: <https://readingfriends.org.uk/resources/>. If you scroll down, you should be able to access all the Reading Friends materials.

